



PLYMOUTH HISTORICAL SOCIETY

2016

Fall

Thomas Hughes Farm

Recently the Plymouth Historical Society received from Sharon (Kinney) Nelson three items that provide more insight into the original Thomas Hughes Farm. A copy of the abstract map with dates for Plymouth farms, picture of original Thomas Hughes farm house and a painting that reflected the era after the original farm house burned in 1914 and was now owned by William Hughes. It was reported that the family lived in a shed until the new farm house was built in ca 1920. William Hughes was the grandson of Thomas Hughes Sr. and was the last one to farm the land. He was the grandfather of Sharon (Kinney) Nelson. William Leroy "Willie" Hughes was born July 25, 1885, died July 20, 1966 and is buried in Parkers Lake Cemetery.

The new farm house was probably a kit house called a "4-Square or Corn Belt Cube" house. The details aren't known but it was probably purchased from Sears Roebuck & Co. In farm country they were typically delivered by train and hauled by horse and wagon to the farm. The cost of the kit is unknown but estimated to be \$1000 to \$1500 depending on options.

The land was sold for development and the barns torn down but the house lives on. It has been beautifully restored and cared for by Mr. Diaz. It is one of two known "4-Square or Corn Belt Cube" houses still preserved in Plymouth. There are probably several more kit homes in Plymouth but requires detective work to find them.

Thomas Hughes was born in England on November 25, 1803. He served in the British Army for five years. In February 1824 he married Hannah Buckell. To this union, nine children were born. James, MaryAnn, John, who died, Thomas, Henry, Charles, Ellen (deceased), Edward and Ellen 2nd, who also died. In the year 1849, Thomas brought his wife and children (except for James the eldest) and located in Burlington, Iowa, where they lived for five years. In the fall of 1853, they moved to Minnesota and settled on a claim, section 19, in Plymouth. The date of actual purchase was October 18, 1860. At the time he came there were no roads except the Indian trails used by Shakopee and his band of Sioux. Here he built a home and lived until his death in 1887. His wife had died in 1882. Both are buried in Parker's Lake Cemetery.

Excerpt from the Thomas Hughes history at Plymouth Historical, the link below provides the whole article.

[1997 November Newsletter - "Descendants of Thomas Hughes"](#)

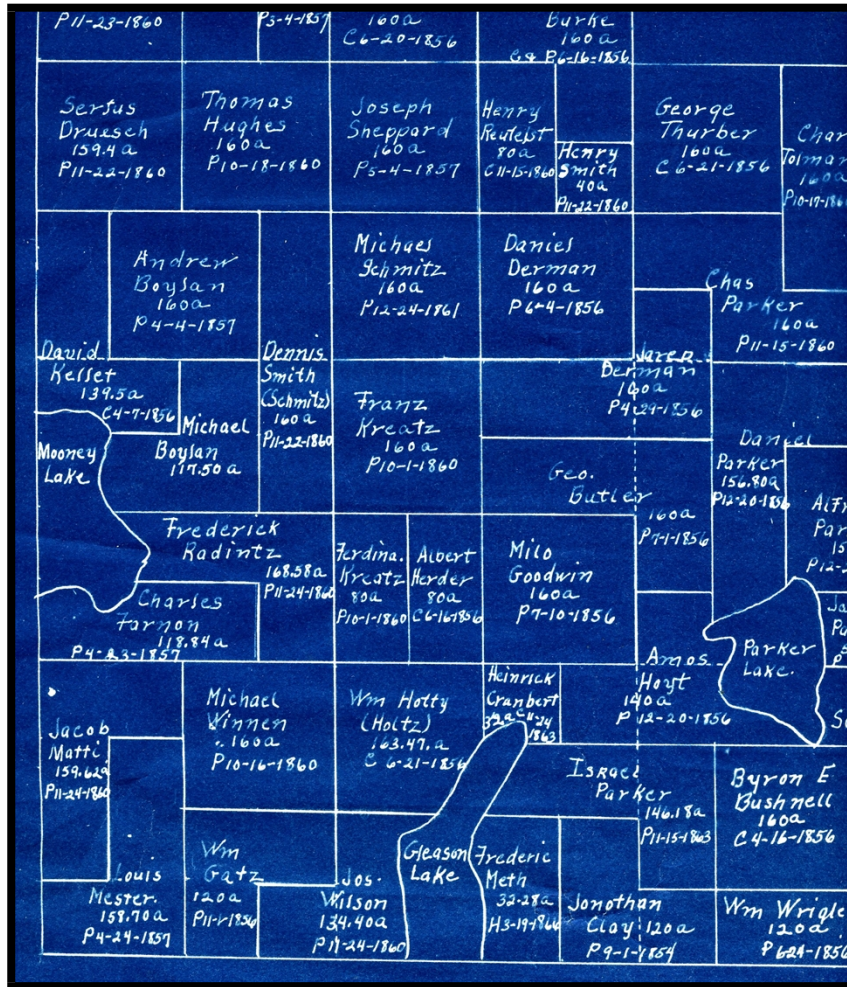

A portion of the Abstract Map with Thomas Hughes 160 acres listed in up left hand corner. Today Hwy 101 and Cty Road 24 intersect the 160 acres approximately in the middle of his land



Circa 1900 to 1914 as the farm house burned in 1914 Today that is Hwy 101 heading north and picture taken approximately at Cty Rd 24 intersection.



**Painting by Gladys Grendall - 1971 reflecting what it would have looked like in 1930's
County Road 13 (now Hwy 101) runs between house and barn**



Front of house facing Hwy 101



The back (now front) of house facing Queensland



Fun Picture -Max Berthiame in 1930 with load of hay on Model T

X.Y. Benefit Association Picnic

Plymouth Historical has a large panoramic photograph of the X. Y. Benefit Association picnic at Parkers Lake. We could find no information about who was this X. Y. Benefit Association? Mystery solved by Ted Hoshal who provided a wonderful printed program of the picnic events. It is in such wonderful condition it looks like it was printed in August of 2016 instead of 1919. It was a company picnic of the Wyman, Partridge & Co. a large dry goods company in Minneapolis. The building is still standing in the warehouse district in Minneapolis.

The Wyman, Partridge Co. had company picnics at Parkers Lake on Saturdays for several years. The picture is of the picnic on August 17, 1918 and the program is for August 16, 1919. Just think you could rent a bathing suit, locker and towel for .25 cents. Portions of the program are shown below.

The program pamphlet is a wonderful addition to the history of Plymouth. The picnics, dancing, sports, etc. at Parkers Lake by organizations and companies was a very large activity from about 1914 up until the 1930's with the ease of travel out of the Minneapolis on the Luce Line (think light rail).



The panoramic picture was taken south of the Luce Line in a large picnic area owned by the railroad. The area is now filled with homes, also note on the right side the Luce Line train on tracks by Parkers Lake

X. Y.
Benefit Association
PICNIC



Parker's Lake
AUGUST 16, 1919.

Parker's Lake, August 16, 1919

Picnic Information

Row Boats.
May be rented at twenty-five cents per hour at pavilion.

Bathing.
Bathing suit, towel and locker..... 25c
Towel and locker 15c

Dancing.
No charge. Rahn Orchestra. Five pieces.

Refreshments.
Refreshments served at our stand. Use your tickets. Coffee and cream furnished at our stand free.

Train Service.
Our special train leaves station (Second Avenue North and Seventh Street, Luce Line), at 9:00 A. M.
1:30 P. M. Special
Those who can not leave at 9 A. M. can take regular trains.
Regular train schedule going out:
4:20
Tickets good on any train.

Note.—Everyone should be at station at 8:45, latest. Remember our special train leaves at 9:00 A. M. sharp.

What to Bring:
Your lunch.
Your own cup and pail for coffee.
Knives, forks and spoons.
Sugar for your coffee.

Who Must Go:
All X. Y. employees.

Who May Go:
Everybody welcome.
All the following events are for the factory employes only:

| | |
|--|--|
| <p style="text-align: center;">X. Y. Benefit Association Picnic</p> <hr style="width: 10%; margin: auto;"/> <p style="text-align: center;">12:00 M. INTERMISSION FOR LUNCH</p> <hr style="width: 10%; margin: auto;"/> <p style="text-align: center;">1:30 P. M. ASSEMBLE FOR GROUP PHOTO</p> <p style="text-align: center;">2:00 to 4:00 P. M. SPECIAL EVENTS AND RACES</p> <p style="text-align: center;">NO. 3. FIFTY YARD DASH (Ladies) First Prize—Silk Hose Second Prize—Apron</p> <p style="text-align: center;">NO. 4 SACK RACE (Men) First Prize—Silk Hose Second Prize—Necktie</p> <p style="text-align: center;">NO. 5 POTATO RACE (Ladies) First Prize—Kid Gloves Second Prize—Silk Gloves</p> <p style="text-align: center;">NO. 6 FIFTY YARD DASH (Men) First Prize—½ doz. Handkerchiefs Second Prize—Gentleman's Belt</p> <p style="text-align: center;">NO. 7 BALL THROWING CONTEST (Ladies) First Prize—Camisole Second Prize—Brassiere</p> | <p style="text-align: center;">Parker's Lake, August 16, 1919</p> <hr style="width: 10%; margin: auto;"/> <p style="text-align: center;">NO. 8 RELAY RACE (Ladies) One Team from each Department Prize—Box of Candy to each member of winning team</p> <p style="text-align: center;">NO. 9 FIFTY YARD DASH (Foreladies) Prize for Everyone</p> <p style="text-align: center;">NO. 10 TUG OF WAR (Men) Manufacturing Department vs. Cutting Department Prize—Box of Cigars</p> <p style="text-align: center;">NO. 11 CHICKEN RACE (Ladies) Prize—Chicken</p> <p style="text-align: center;">4:00 P. M. to 5:30 P. M. DANCING</p> <p style="text-align: center;">5:30 P. M. to 6:30 P. M. SUPPER</p> <p style="text-align: center;">6:30 to 7:00 P. M. COMMUNITY SING Miss Lucille Halliday, Director</p> <p style="text-align: center;">7:00 to 9:30 P. M. DANCING</p> <p style="text-align: center;">9:30 to 10:00 P. M. Pack up for home. Our special train leaves promptly at 10:00 P. M. Regular trains leave Parker's Lake for Minneapolis, 5:15 P. M. Tickets good on any train.</p> |
|--|--|

Old Fashioned Christmas

On Saturday, December 10th from 2-5 pm, the Plymouth Historical Society and the Plymouth Park & Recreation Department are co-sponsoring the 30th Annual “OLD FASHIONED CHRISTMAS IN PLYMOUTH”. The purpose of the event is to provide some old fashioned holiday spirit and activities for families in Plymouth. Children can visit with Santa and Mrs. Claus will be right there to help the Elves hand out candy canes. The children can also see Santa’s reindeer and go for a hay ride pulled by Belgian horses with bells jingling. The rides are free, hot cider and cookies will be provided; carolers and making Christmas decorations are other activities for the children.

This year we again have our great story teller back. Bob Gasch will be telling holiday stories in the Carriage House, something you don’t want to miss! Also the Armstrong Chamber Singers will be singing holiday songs and delighting the children young and old.

Bring your friends, relatives, neighbors and kids ages 1 month to 100 years young. The annual event has attracted large crowds with some families having a perfect attendance record with their children since it started in 1987. We had a great time last year as we do every year

Activities include:

Visit with Santa

Live Reindeer

*Old Fashioned Hay
Ride*

Hot Cider and Cookies

*Old Fashioned Xmas
Decorations*



Old Toy Train Display

Crafts

*Story Telling by
Bob Gasch*

*Music Groups
Armstrong Chamber
Singers
Messiah Recorder
Ensemble*

Plymouth History Tour

Here are several pictures from the Plymouth History Tour Sunday October 9th.



School Tours of PHS

Plymouth Historical Society again this fall hosted eight 2nd grade classes from Oakwood and Birchview Schools.



Plymouth Parade

The Plymouth Historical Society participated in the Plymouth Parade on September 24th.



Website

The Plymouth Historical Society website is:

www.plymouthmnhistoricalsociety.com

Check us out!

Note: All past newsletters dating back to 1986 are available on-line in PDF format for viewing or printing.

Donations

Donated by: Genevieve Lane

- Photographs from Emma Mengelkoch estate

Donated by: Maureen & Joe Brown

- \$25.00

Donated by: Western Suburban Ladies Club

- \$100.00



Meetings

The Museum is also open the 1st and 3rd Sunday of the month in the afternoon from 1:00 to 3:00 PM during the Spring, Summer and Fall.

The monthly business meetings are held on the 4th Monday of the month at 7 p.m. in the Plymouth Historical Society Building, located at 3605 Fernbrook Lane North, Plymouth, MN.

Open by special appointment in January, February & March.

Current Officers

The following are the present officers:

| | | |
|----------------|-----------------|--------------|
| President | Dennis Jacobson | 763-972-0988 |
| Vice President | Kay Bertrand | 763-249-0138 |
| Secretary | Betty Jacobson | 763-972-0988 |
| Treasurer | Gary Schiebe | 763-473-4889 |

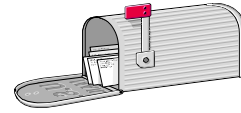

Mailing and Membership List

If you are not a member and want to sign up or if you have any questions, please call:
Kay Bertrand, 763-249-0138.

The 2017 annual dues are:

| | |
|---------------------|----------|
| Individual | \$10.00 |
| Family | \$15.00 |
| Individual Lifetime | \$100.00 |
| Family Lifetime | \$150.00 |

If you would like the newsletter delivered via E-mail please notify Kay Bertrand or send an e-mail to:
info@plymouthmnhistoricalsociety.com

If you do, it is a plus for both of us. When you receive via e-mail it will be in color. When sent by mail it is in black and white and costs PHS about \$2.00 per copy to print and mail